

RECTANGULAR & SQUARE FACE TIPS

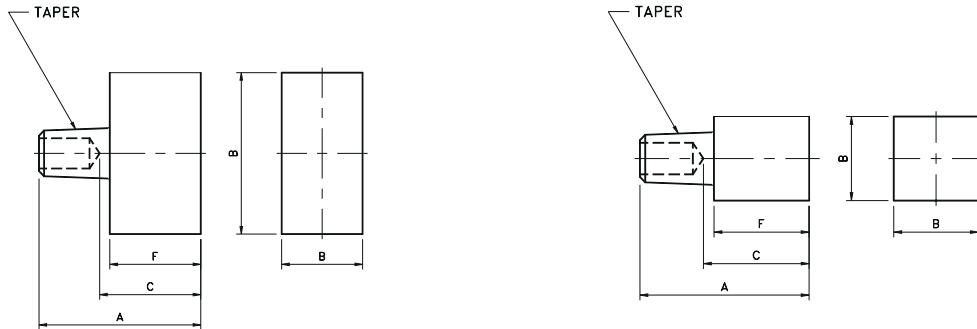

| EXAMPLE OF PART CODING | | |
|------------------------|---|---|
| TS | = | TIPALOY SQUARE/ RECTANGULAR FACE |
| 2 | = | RWMA CLASS 2 COPPER |
| 5 | = | #5 RW TAPER |
| 24 | = | LENGTH IN 1/16" (24 = 1-1/2") |
| 10x16 | = | WIDTH X LENGTH OF FACE IN 1/16" (10X16 = 5/8" X 1") |
| 18 | = | WATER HOLE DEPTH (IF DIFFERENT THAN STD. 7/8") |
| CT | = | COPPER TUNGSTEN FACING |

RECTANGULAR FACE TIPS

| Taper | #130 Code No. | Previous Code No. | Overall Length | Weld Face Dimension | Face to Water Hole | Length of Face |
|--------------------|----------------|-------------------|----------------|---------------------|--------------------|----------------|
| | Class 2 | | A | B | C | F |
| 4 RW Taper (#1 MT) | TS-24-25-10X32 | SP-220-1 | 1-9/16 | 5/8 x 2 | 13/16 | 11/16 |
| | TS-24-26-8X16 | SP-248-1 | 1-5/8 | 1/2 x 1 | 1/2 | 1 |
| | TS-24-24-8X8 | SP-261 | 1-1/2 | 1/2 x 1/2 | | 7/8 |
| | TS-24-24-8X16 | SP-271-1 | 1-1/2 | 1/2 x 1 | | |
| | TS-24-35-4X16 | SPB-329-1 | 2-3/16 | 1/4 x 1 | 1-5/16 | |
| 5 RW Taper (#2 MT) | TS-25-25-10X32 | SP-220-2 | 1-9/16 | 5/8 x 2 | 13/16 | 11/16 |
| | TS-25-29-10X16 | SP-248-2 | 1-13/16 | 5/8 x 1 | 11/16 | 15/16 |
| | TS-25-24-10X16 | SP-271-2 | 1-1/2 | | 1/2 | 5/8 |
| | TS-25-28-10X10 | SP-291 | 1-3/4 | 5/8 x 5/8 | 3/4 | 7/8 |
| | TS-25-35-4X16 | SPB-329-2 | 2-3/16 | 1/4 x 1 | 1-5/16 | 1 |

* Additional rectangular or square face sizes and lengths available.